

Lockey M213 Installation Instructions

Parts List

NO.	Name of Parts	M213
1	Outside Body	1
2	Inside Body	1
3	Rubber Escutcheon	1
4	Hold-Open Switch	1
5	Spindle for Right Handed Door	1
6	Spindle for Left Handed Door	1
7	Machine Screw M4 x 50mm	2
8	Machine Screw M4 x 35mm	2
9	Wood Screw M4	4
10	Extra Combination Tumblers (Red)	1
11	Extra Non-Combination Tumblers (Blue)	2
12	Nite-Latch	1
13	Tweezers	1
14	Hexagonal Bolts	2

Outside Body Diagram

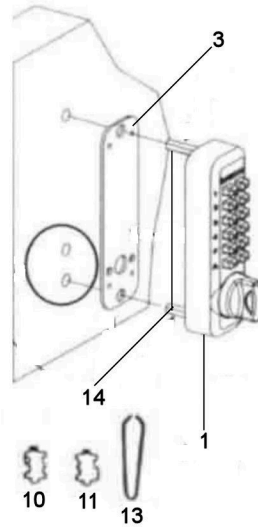

Inside Body Diagram

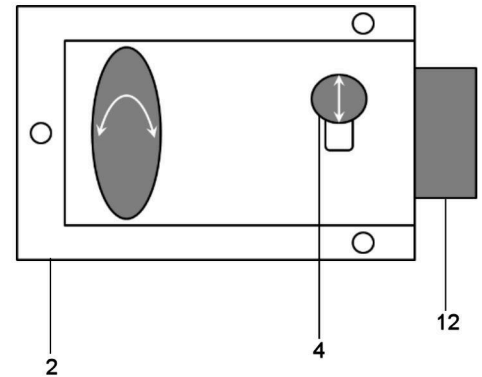

Instructions

PLEASE NOTE: You must secure the Outside Body to the door before mounting the Inside Body.

1. Before installing, change your User Code, referencing the "How to Change Code" instructions.
2. Determine door handing. From the exterior of the door, a Right-Handed door will have hinges on the right side of the door and a Left-Handed will have hinges on the left side of the door. Change handing of lock as needed using included "M210" Instructions.
3. Using Inside Body template, determine and mark desired placement (trace outline of body) and mark "through" holes.
4. Drill "through" and spindle holes.
5. Determine correct spindle. There are two (2) spindles included, one for Right-Handed and one for Left-Handed configurations.
6. Ensure Hexagonal Bolts (#14) are attached to Outside Body.
7. Mount Outside Body on door, guiding hexagonal bolts through the top and bottom "through" holes.
8. Secure Outside Body to door using the included washers (2) and machine screws (2).
9. From the interior of the door, place flat end of spindle through the spindle hole into the Outside Body ensuring that it is positioned correctly. The twisted end of the spindle should now be exposed through the interior of the door.
10. Mount Inside Body on door ensuring that the spindle is positioned correctly and engages the lock.
11. Secure Inside Body to door using provided wood screws.
12. Test lock to ensure proper operation and correct handing.